

PRINTABLE INFO SHEET

Series: Grandville LE Ranch
 Model: GHC222A Grandville Ultra 5

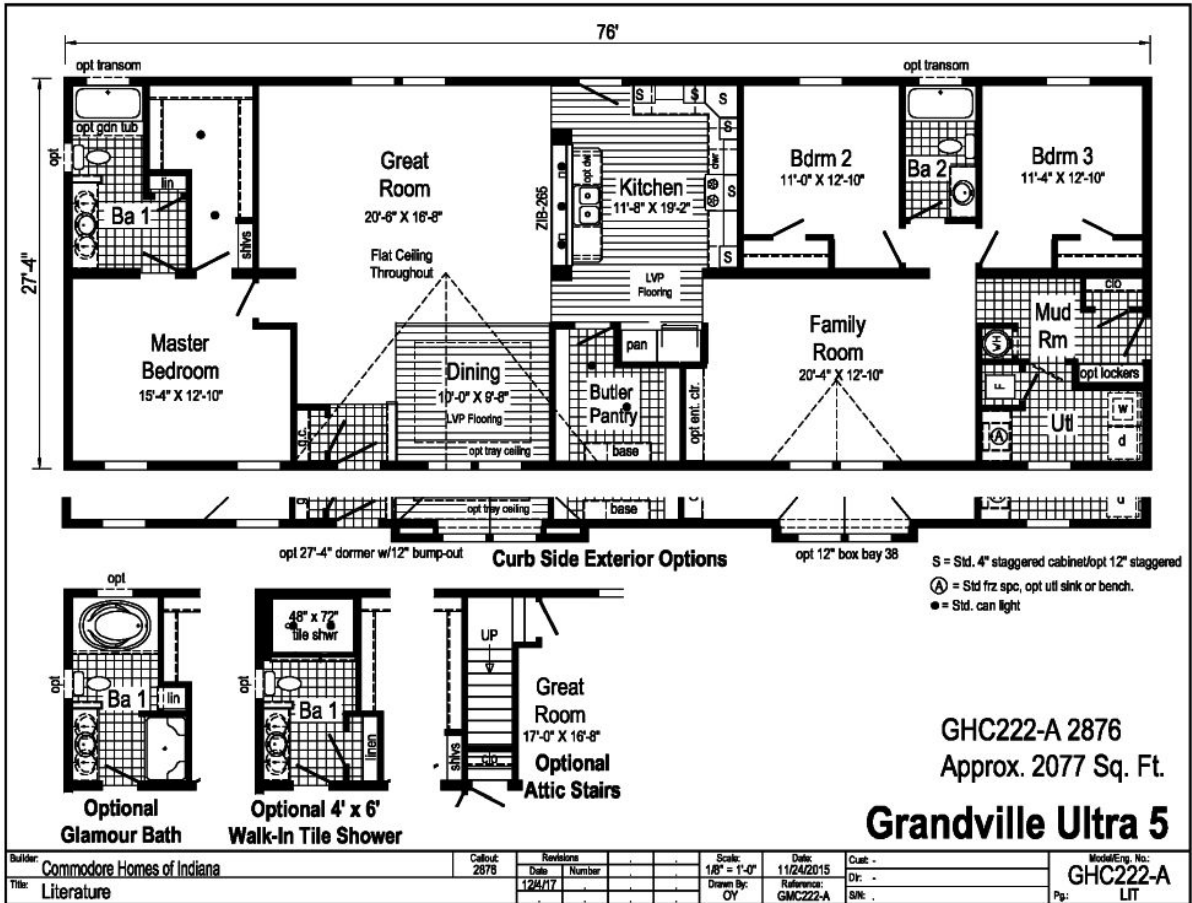

About This Model

Style: Ranch / Bedrooms: 3 / Bathrooms: 2 / Square Feet: 2077

CUSTOMER CONTACT

Notes:

PRINTABLE INFO SHEET

Series: Grandville LE Ranch
Model: GHC222A Grandville Ultra 5



Standards & Features

Interior

Smooth Drywall Throughout
Stipple Ceiling
Flat Ceiling with 8'0" Sidewall
Coveless Ceiling Joints
Brushed Nickel Langford 3-Arm Dining Room Light
Alabaster Glass Pendant Nook Light
Glass Light Shades Throughout
Mortise Door Hinges
Metal Interior Passage Sets
Floor Mount Door Stops
Smoke Detectors with Battery Back-Up
Wire Shelving in Guest Closet
Brushed Nickel Interior Package
Includes: Door Handles, Hinges, Huntington Brass Metal Faucets and Cabinet Hardware

Exterior

Patina Lantern Light at Front Door
Patina Square Light at Rear Door
One GFI-Protected Exterior Receptacle
Vinyl Dutch Lap Siding with Larger Starter Strip to Cover Sill Plate
O.S.B. Sheathing Under Siding
Fixed Roof with Shingles and 10" Eaves
Ridgevent Roof Ventilation System
3/0x6/8 6-Panel Fiberglass Front and Rear Door with Deadbolt Lock
Vinyl Insulated Low-E Windows
12" Raised Panel Shutters on Front Door Side

Construction

Floor System on 16" Centers with $\frac{3}{4}$ " OSB Decking***
2x6 Floor Joist on 28 Wide Models
2x8 Floor Joist on 32 Wide Models
2x6 Exterior Walls on 16" Centers**
2x4 Interior Walls
30# Roof Load
Recessed Frame Design without Perimeter Blocking

Kitchen

GE 30" Standard Gas Free Standing Range with Electronic Ignition
Power Range Hood with Light
GE 18 Cubic Foot, No-Frost Refrigerator with Icemaker
Stainless Steel Double Bowl Sink (33x22x8)
Tight Mesh Shelving in Pantry
One USB Recept

Baths

60" One-Piece Fiberglass Tub/Showers
One-Piece Fiberglass Shower with Glass Door in Glamour Baths
Fiberglass Soaker Tub in Glamour Baths
Anti-Scald Valves on Showers & Tubs
1.6 Gallon Per Flush Elongated Toilets
China Stool, Tank, and Lid
China Sinks with Overflows and Pop-Up Drains
Lighted Vent Fan in Each Bath
Factory Framed Mirrors - All Baths

CUSTOMER CONTACT

Notes:

PRINTABLE INFO SHEET

Series: Grandville LE Ranch
Model: GHC222A Grandville Ultra 5



Standards & Features (continued)

Cabinetry

- Evermore Custom Cabinetry (KCMA Certified)
- Hardwood Oak Mission Flat Panel Cabinet Doors
- Crown Moulding on Overhead Cabinets
- Contemporary Cabinet Hardware
- 30" Height Overhead Cabinets
- 4" Staggered Overhead Cabinets
- Lined Overhead Cabinets
- Adjustable Shelves in Overhead Cabinets
- Dovetail Drawer Construction
- Full Extension 75# Drawers Guides
- Base and Center Shelf in Base Cabinets
- Wilson Art Laminate Countertops with Laminate Edging
- 4" Wilson Art Laminate Backsplash
- 33" High Vanities
- Base Shelf in Vanities

Utilities

- 100 AMP Electrical Service
- Copper Wiring Throughout
- Auto Ignition Gas Furnace
- Woodgrain Furnace Door
- Aluminum Heat Ducts
- Air Exchanger System for Furnace
- In-Floor Cross over Heating System
- Air Conditioning Thermostat with 5-Wires
- 40 Gallon Electric Water Heater with Pan
- Main Water Line Shut-Off Valve
- Water Shut-Off Valves - Where Accessible
- Plumb and Wire for Washer
- Wire and Vent for Dryer

Utilities (continued)

- One Exterior Water Faucet

Insulation

- R-11 Fiberglass Insulation in Floor
- R-19 Fiberglass Insulation in Walls
- R-38 Avg. Blown Insulation in Ceiling

Flooring

- Choice of Various Styles of SHAW Carpet with ShawGuard Carpet Protector
- 3 Styles: Mantra, Standout or It's Cozy
- Choice of Several Standard color options and numerous optional colors
- Standard Carpets are all 16 and 18 oz
- Rebond Carpet Pad with Tackstrip Carpet Installation
- Congoleum No-Wax Vinyl Floor Coverings
- Congoleum Entry Foyer Vinyl Flooring

Bedrooms

- Ceiling Lights
- Egress Window Each Bedroom
- Wire Shelving in Wardrobes
- Switched Light in All Walk-In Closets

Energy Efficient Standards Include:

- Low-E Vinyl Insulated Windows
- Fiberglass Exterior Doors
- R-11 Fiberglass Insulation in Floor
- R-19 Fiberglass Insulation in Walls
- R-38 Avg. Blown Insulation in Ceiling

CUSTOMER CONTACT

Notes:
